



LAB | INDUSTRIAL | OFFICE

Custom Furniture. Fast.





Contact us

FORMASPACE

800.251.1505

design.consultant@formaspace.com

Formaspace.com



@formaspace



@RealFormaspace

TABLE OF CONTENTS

WHO WE ARE	3
OUR STORY	4
WHO WE SERVE.....	5
WHAT WE DO	7
PRODUCT VERTICALS	8
PRODUCT TYPES	10
PRODUCT LINES.....	12
HOW WE DO IT.....	36
HOW TO WORK WITH FORMASPACE.....	38
FACILITY	40
CAPABILITIES.....	41
TEAMS	42
SERVICES.....	47
CASE STUDIES	48
VERTICALS	59
LAB APPLICATIONS	60
INDUSTRIAL APPLICATIONS	64
OFFICE FURNITURE APPLICATIONS	69
FSO 3DCONFIGURE TOOL.....	72
CUSTOM FURNITURE SOLUTIONS.....	75
FS MATERIALS & FINISHES.....	76
FSO MATERIALS & FINISHES	80





WHO WE ARE

FORMASPACE advances the spirit of discovery and creation through the design and manufacture of unique furniture solutions. We can work with clients from ideation to installation, in a process we call “total chain of custody.” Architects and designers spec Formaspace for our short lead times, free design services, ease of installation, and our large-scale custom manufacturing capability.

We strive to create great places to work in everything we do. Our team is committed to the greater issues of humanity and equanimity and are devoted to improving the world we work in.



OUR STORY

Over the past 35 years, we have successfully served clients in wet lab, tech lab, material handling, and specialty environments with our durable, unique furniture solutions. Recently, our clients asked us to explore the business of manufacturing office furniture, so we did just that. Staying true to our industrial heritage, we produced a new office product line, Weldmarx™, after 3 years of research and development. Our industrial aesthetic nods to our past yet is a refined, modern take on the industrial trend. We also stayed true to our heritage of modularity and flexibility. Change the frame color, surface material, or leg shape and you have a mid-century modern, post-modern, or traditional design aesthetic.

WHO WE SERVE

Formaspace advances the spirit of discovery and creation through the design and manufacture of custom business furniture. Our furniture marries form to function with flexible solutions for clients in laboratory, industrial, and office environments. Formaspace serves over 80% of the Fortune 500, as well as universities, governments, small businesses, and individuals.



ARIOSA

"Your furniture is as flexible as your service!"

- C. McBride, Director of Operations, Ariosa Diagnostics, A Roche Company



AVIALL

"I recommend Formaspace because they are reliable, timely, and they keep promises."

- J. Carson, Aviall, A Boeing Company



MISSION HOSPITAL

"Efficient, timely and perfect furniture for our lab! We love the flexibility to never-ending changes that occur in laboratory medicine."

- L. Davis, Mission Health Hospital



NIKE INC.

"This product is high quality, at a reasonable price and the customer service is excellent!"

- S. Satterfield, Nike Inc.

MORE CLIENTS

Tech Lab: Dell, Google, Apple, Inc., Intel Corporation, NASA

Government Agencies: Department of Agriculture, Dep. of Defense, Dep. of Transportation, U.S. Armed Services

Universities & Schools: Columbia University, John Hopkins, Northwestern University, Stanford University, University of Texas, Duke

Industrial: Boeing, Ford, General Electric, Toyota, Goodrich Corporation, Ametek, Busch

Retail & Other: Allegra Network, Staples, Williams Sonoma, Inc., Penn Museum, Kuehne + Nagel, Louis Vuitton, Tory Burch, YETI

Wet Labs: Corning, Inc. , Exxon Mobil, Libe Labs, LLP, U.S. Army, Arbor Diagnostics



Custom Furniture. Fast.

WHAT WE DO

Formaspace has two unique brands, Formaspace and Formaspace Office. Formaspace expertise lies in manufacturing wet and tech lab furniture, as well as furniture for material handling and production environments. A few years ago, the market demanded that we begin producing office furniture and thus, Formaspace Office began. Formaspace Office manufactures differentiated, authentic, and unique office furniture solutions. We collaborate with architects, interior

designers, and commercial furniture dealers, to creatively solve workplace design problems.

Our expertise lies in large-scale custom solutions. You imagine it, we build it. Our in-house industrial designers will design and engineer a solution for each of your projects. We will even manage your furniture project from ideation to installation, which is a process that we like to call, "continuous chain of custody."

PRODUCT VERTICALS

Formaspace offers furniture solutions in 3 main verticals: lab, industrial, and office.



LAB

Formaspace designs furniture solutions for all applications of a lab: tech, wet, cleanrooms, and casework.



INDUSTRIAL

Formaspace also designs solutions for industrial applications such as manufacturing, light and heavy assembly, ESD repair, and shipping & receiving.



FORMASPACE
office

OFFICE

Formaspace Office creates unique office furniture solutions in a range of applications such as open offices, private offices, conference rooms, and lounges.

PRODUCT TYPES

01

Standard

Our standard products are the most economical and quickest to ship. If you're working with short deadlines or strict budgets, our standard line will fulfill your requirements while exceeding industry standards with the highest quality materials. Choose from our Basix™, Bench Plus™, or Benchmarx™ configuration.

01



03

Custom

Many environments require task-specific designs. Our team of engineers specializes in custom furniture design and consistently provides workplace-efficiency solutions.

With our team, you get workplace furniture that increases spatial efficiency, organization, employee productivity, and a modular, scalable design tailored to your workflow. Contact our technical sales team to start designing your custom workspace.

02

Modified

Enhance our pre-engineered product configurations with modifications that suit your specific environment. Start with a Basix™, Bench Plus™ or Benchmarx™ and add the modifications you desire.

02

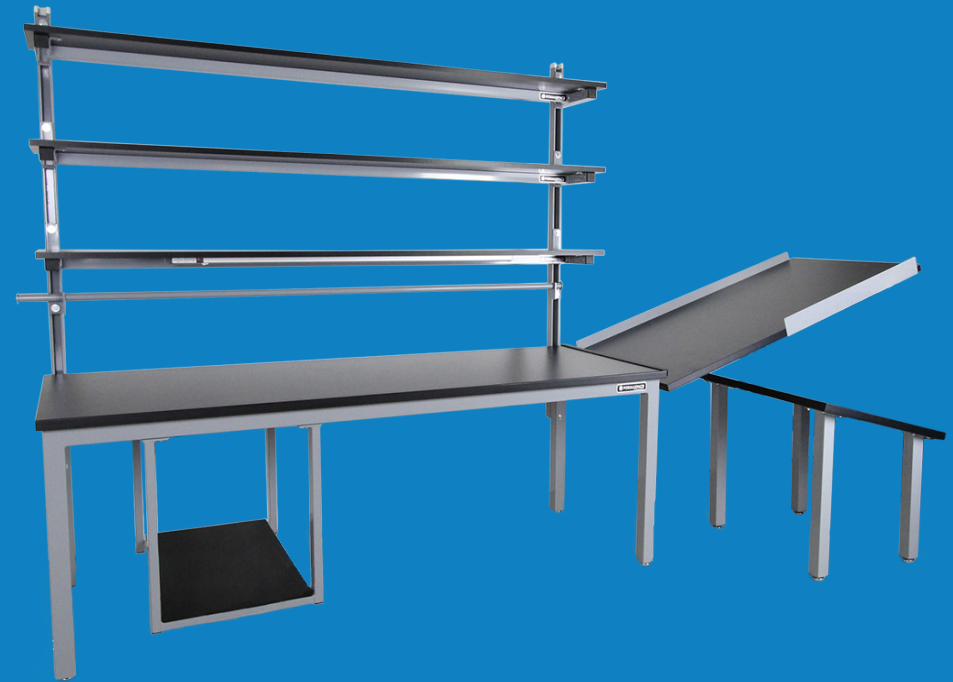

03



PRODUCT LINES

Formaspace has two standard product lines, one under each brand. Formaspace has a standard product line of 3 benches, and Formaspace Office has a standard line that consists of several desking products, conference tables, and accessories. Continue reading to learn more about each product!



5.0

5.0 is Formaspace's standard product line. These products ship quicker and are the most economical solution for your project. We have three standard benches that you can choose from - **Benchmark™**, **Bench Plus™**, or **Basix™**. Continue reading to learn more about how each workbench can be modified or customized to fit your unique needs!

Basix™

Formaspace **Basix™** lab tables are popular for use as flexible islands within a complete tech lab, wet lab, or material handling furniture system. **Basix™** tables are frequently designed to accommodate custom cubbie configurations to maximize storage of frequently used items and are often designed with total-lock casters for maximum flexibility in reconfiguration.



Bench Plus™

Formaspace **Bench Plus™** tables are popularly utilized as individual workstations or task-specific areas within a complete lab or material handling furniture system. This bench includes an adjustable shelf above the work surface. Under the standard selections, the shelf depth is either 12" or 15". **Bench Plus™** is frequently modified to include a customized reagent shelf on top of the shelf to maximize storage of frequently used items. They are often designed with total-lock casters for maximum flexibility in a modular wet lab, tech lab, or material handling set up.



Benchmarx™

Our most popular laboratory workbench, the **Benchmarx™**, is renowned for its high durability, task-specificity, and variety of modular and custom options such as multiple surface choices. A **Benchmarx™** bench can be built as a stand-alone unit or as part of an integrated lab furniture system.

In a typical small to medium sized laboratory setting, Benchmarx™ workbenches line the walls of the room in a U-shape. As part of an overall workspace design in larger labs, **Benchmarx™** benches are typically configured in continuous rows. **Benchmarx™** benches are designed to maximize storage and flexibility for future re-tasking needs. In addition to being great in wet and tech labs, they also are very functional in material handling facilities.

Triton™

Triton™ service bench modules connect to service panels above the workbench for maximum flexibility. Service options include fixtures to deliver gas, water, and air utilities to the workspace alongside data and electrical outlets on the power bar.

Modular. Adaptable.

Services:

Select your laboratory services, and we'll customize each lab bench to your process. Need unique services? We can do that too.

- gas
- vacuum
- air
- water
- data
- power

Surfaces:

We have a variety of work surface materials for chemical resistance, temperature resistance, levels of hardness, and aesthetics.

- epoxy
- phenolic
- steel
- stainless
- hdpe

Shelving:

Select your material preference to fit your lab requirements.

- steel
- phenolic
- stainless
- laminate
- hdpe

Storage:

The Integrated Lab Services Bench features adjustable cabinetry. Move under mounted storage from left to right as desired.

- cabinets
- drawers
- waste disposal
- vacuum pump cabinets
- custom combos



Architecturally specified furniture increases the long-term functionality of laboratories. Ask your Design Consultant for drawing files to include these products in your next lab project.

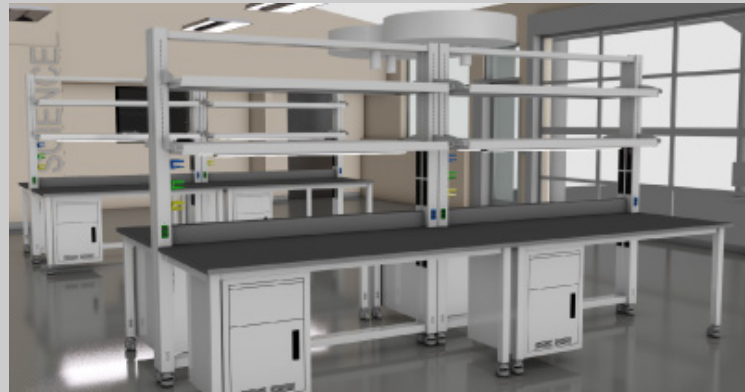

Customizable. Adjustable.

System Parts:

Select your laboratory services, and we'll customize each lab bench to your process. Need unique services? We can do that too.

- end frames
- center frames
- upper h-frame
- intermediate frame
- bottom floor frame
- demising panels
- pvc extrusion
- shelf bracket

Modifiers:

Custom configure your FabWall™ to your lab project through shelving, surfaces, cabinetry, pedestals, and parts.

Accessories:

Add accessories to your FabWall™ modules to increase partition functionality.



"Efficient, timely, and perfect furniture for our lab! We love the flexibility to never-ending changes that occur in lab medicine."

- L. Davis, Mission Health Hospital

FabWall™

Infinitely customizable and adjustable, the **FabWall™** is ideal for labs seeking future flexibility. Discover the optimal furniture solution with our Design Consultants for your next laboratory project. Need it fast? Take advantage of our 3 week lead times!



FORMASPACE

office

Weldmarx™

It all started with one of the largest dealers on the West Coast and architects across the country that were looking for more than just a height adjustable work surface, but a unique desk that was independently modular and height adjustable. The dealer and end-user wanted style and quality for an affordable price. We gladly took on that challenge.

We tirelessly refined our product offering for the past three years to finally reveal a desk that was first of its kind, the ideal industrial-style sit-to-stand desk. All this led to **Weldmarx™**, our premier line of office furniture products.

View our industrial office furniture line here!



OFFICE DESKS

WELDMARX I

Sit To Stand Desk

Weldmarx I is not only BIFMA compliant but is tested to double BIFMA requirements. It's twice as strong and twice as durable as BIFMA compliant competitive products. You can find height adjustable work surfaces from many manufacturers, but Formaspace Office created a desk that raises, lowers, and moves as one independent piece of furniture. Our modular sit-to-stand office desk can be manufactured with 3 different hardwood surface options, 5 standard laminate options, and can be powder coated with 10 standard frame colors. Customize this piece to revolutionize your office project!



WELDMARX II+

Series Benching

Weldmarx II+ Series Desk System is designed for open offices and companies that require flexibility for changing dynamics. Each twin desk system gives plenty of space to workers and independently functioning height-adjustability gives them an ergonomic experience. Upon request, privacy panels can be utilized as communication boards. Furnish your open office with **Weldmarx II+** and expand it one twin bench at a time as the need arises.



WELDMARX IV

L-Shaped Left Desk

Formaspace L-shaped desks are a combination of the starter desks: Weldmarx III and the desk returns: Weldmarx V. Depending on the office layout or the hand preferences, L-Shaped Left or L-Shaped Right desks can be considered. **Weldmarx IV** is the L-Shaped Left desk where the return is attached to the left-hand side. Any lefty would appreciate the additional space dedicated to the dominant hand. With the additional desk return, an L-Shaped Left desk is a great option for multi-purpose office spaces and efficiently utilizes the work surface for various tasks.

WELDMARX III

Private Office Desk

Weldmarx III is the starter piece that is the essential cornerstone of our private office desk system. It reflects the strength and character of the industrial office design. If your project's design concept doesn't support the industrial-look, consider **Weldmarx III** with a pigmented powder coat frame color. Customize it to match your design and create a competitively priced private office set up that offers Formaspace's quality & strength.



WELDMARX V

Desk Return

Weldmarx V is the desk return extension to the starter desk Weldmarx III. L-Shaped desks are built by attaching **Weldmarx V** to Weldmarx III. Returns are ideal for converting your office desk into a multi-purpose workspace or having meetings with your colleagues. The options include left or right desk returns. The office layout or the dominant hand dictates where to install the return extensions. Depending on the choice, Formaspace offers L-Shaped Left and L-Shaped Right office desks.



WELDMARX VI

L-Shaped Right Desk

Formaspace L-Shaped desks are a combination of the starter desks: Weldmarx III and the desk returns: Weldmarx V. Depending on the office layout or the hand preferences, L-Shaped Right or L-Shaped Left desks should be considered when creating a multi-purpose office space. **Weldmarx VI** is the L-Shaped Right desk, where the return is attached to the right-hand side. The L-Shaped Right desk not only offers an abundance of counter space but also increases the productivity as the individual doesn't need to move around as much while completing various tasks. Consider customizing the L-Shaped desks to accommodate your client's workflow or your project's design elements.



WELDMARX VII

Tilting Top Training Table

Create a multi-functioning training room, conference space, or common area with our nesting table, **Weldmarx VII**. With the help of features like mobility and the tilting functionality, you can repurpose the entire space for different activities as you nest **Weldmarx VII** in a corner and quickly create an open space. You can always customize **Weldmarx VII** with different top materials, frame finishes, and accessories to match your office aesthetic or project purpose.



CONFERENCE TABLES

1. Choose your desired top shape and size

See hardwood and laminate top surface options on page 80.

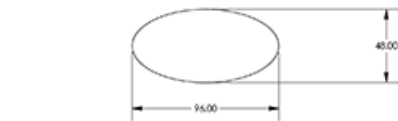

Ellipse
Size Options:
- 1 Piece - 96"W x 48"D

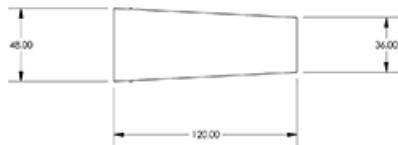

Trapezoid
Size Options:
- 1 Piece - 120"W x 48"D



Single Piece Rectangle
Size Options:
- 1 Piece - 72"W x 36"D
- 1 Piece - 96"W x 48"D
- 1 Piece - 120"W x 48"D



Single Piece Race Track
Size Options:
- 1 Piece - 72"W x 36"D
- 1 Piece - 96"W x 48"D
- 1 Piece - 120"W x 48"D



Round
Size Options:
- 36 Dia.
- 42 Dia.
- 48 Dia.

2. Choose your base

Note: The cone base and round top are exclusively offered together. See powder coat color options on page 80.

"A" FRAME BASE

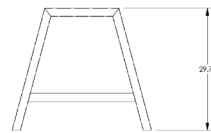

SIZE OPTIONS:
- 34" W
- 46" W

"EIFFEL" FRAME BASE

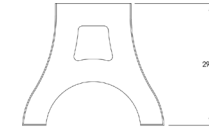

SIZE OPTIONS:
- 34" W
- 46" W

CONE BASE

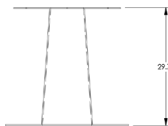

SIZE OPTIONS:
- 26" DIA.
OTHER DIA. BASED ON COST

"V" FRAME BASE



SIZE OPTIONS:
- 34" W
- 46" W

3. Choose your accessories

We offer different accessory options depending on your office's needs. See options on page 81.

AVAILABLE TABLE SIZES

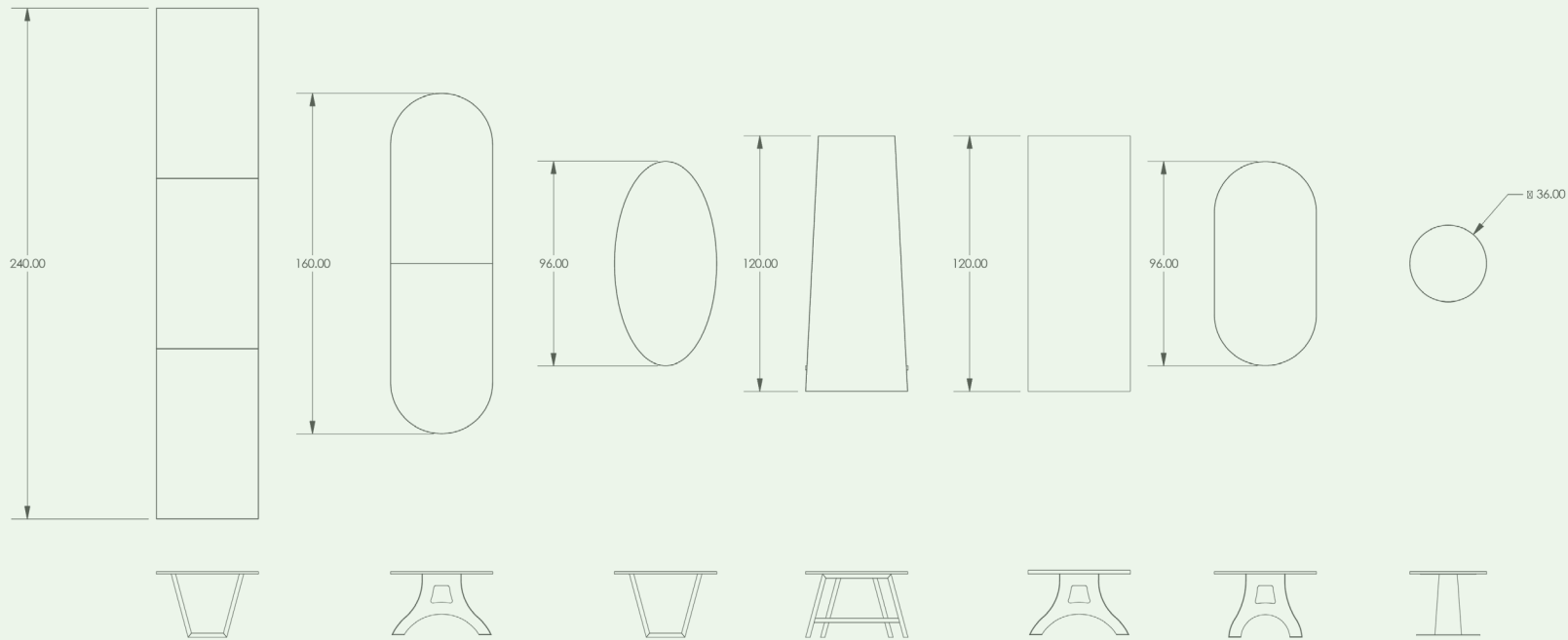

Note: These are the different widths available for the different table leg options.

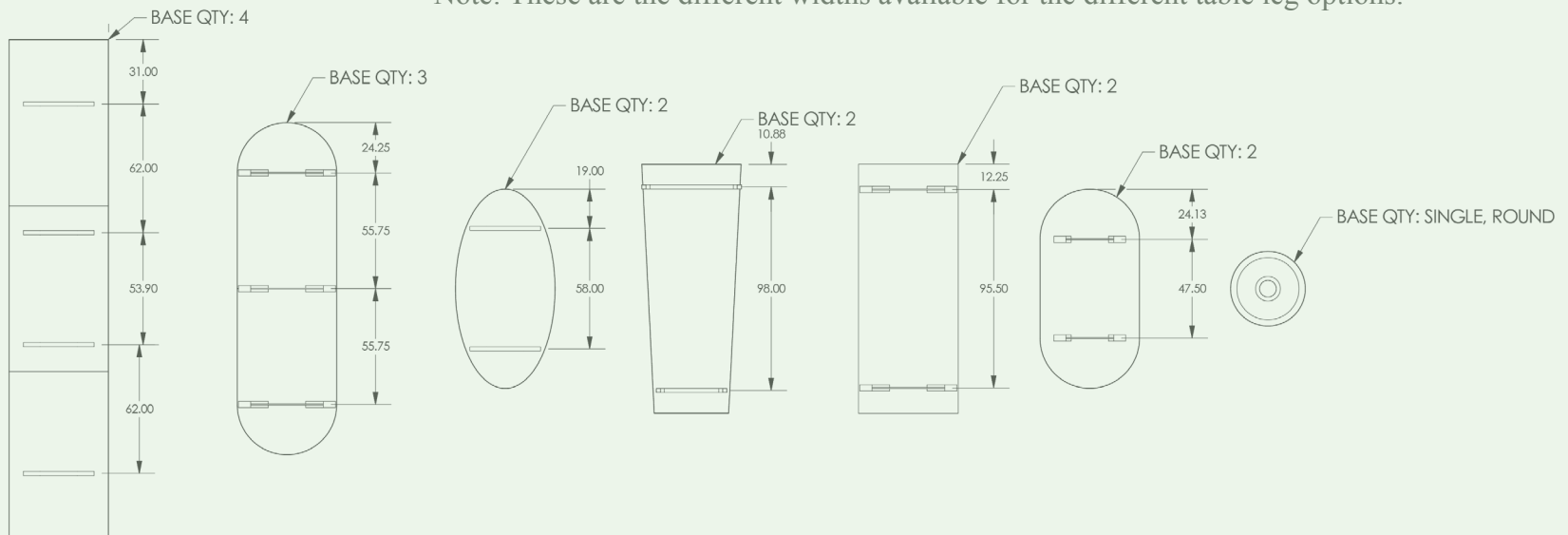

WELDMARX CI

Round Collaboration Table



Whether it is for learning or brainstorming, Formaspace collaboration tables are the right fit for small groups or tight spaces. Depending on the size of the table, **Weldmarx CI** can accommodate a group of 4 or 5 individuals comfortably. The cone-shaped base maximizes the collaborator's leg space, and the steel frame offers the highest stability and durability. Choose from various countertop options and sizes for your next meeting space project.



WELDMARX CI
36" Florence Walnut Laminate Top
Textured White Cone Base



WELDMARX CI
42" Astro Strands Laminate Top
Gloss Black Cone Base



WELDMARX CI
42" Hardwood Maple Top
Pastel Green Cone Base



WELDMARX CI
42" Hardwood Walnut Top
Pearl White Cone Base

WELDMARX CII

Ellipse Conference Table

Weldmarx CII is the ellipse-shaped conference table. Its sleek design gives better visibility to all attendees when compared to a rectangle or a racetrack conference table. With softer edges and flowing design, the ellipse conference table offers an absolute fit for modern office spaces. Even though the standard table comes with a “V” frame base, the **Weldmarx CII** can be customized with different countertop and frame options.



WELDMARX CII

96” x 48” Florence Walnut Laminate Top
Two 34” x 30” Pastel Green V Frame Bases



WELDMARX CII

96” x 48” Hardwood Walnut Top
Two Pastel Green Eiffel A Frame Bases



WELDMARX CII

96” x 48” Hardwood Maple Top
Two Textured White Eiffel A Frame Bases



WELDMARX CII

96” x 48” Carbon Mesh Laminate Top
Two Pastel Blue V Frame Bases

WELDMARX CIII

Trapezoid Conference Table



The shape of the conference table plays a critical role in the success of a meeting. **Weldmarx CIII** is a revolutionary conference table with its trapezoid shape since it puts the presenter at the center of attention. There, the presenter can focus on group dynamics by having the right angle for every attendee surrounding the table. Depending on the conference room size or the brand aesthetics, the countertops, legs, and frame colors can be customized.



WELDMARX CIII
120" x 48" Solid Maple Butcher Block Top
Two 16-gauge 34" x 46" Textured White A Frame Bases



WELDMARX CIII
120" x 48" Carbon Mesh Laminate Top
Two 34" x 46" Pastel Green V Frame Bases



WELDMARX CIII
120" x 48" Astro Strandz Laminate Top
Two 34" x 46" Clear Matte V Frame Bases



WELDMARX CIII
120" x 48" Walnut Hardwood Top
Two 34" x 46" Textured Black Eiffel Frame Bases

WELDMARX CIV

Racetrack Conference Table



Weldmarx CIV, the racetrack shaped conference table, is similar to a rectangular conference table. The main difference between the two is that racetrack option provides a more efficient seating space and allows for easier chair movement. Customize your **Weldmarx CIV** conference table with various top and base options and expand it up to 20 feet. Create the right aesthetic with powder coating color options and surface materials.



WELDMARX CIV
96" x 48" 5th Avenue Elm Laminate Top
Two 34" x 30" Pastel Blue V Frame Bases



WELDMARX CIV
120" x 48" Black Laminate Top
Two 46" x 30" Textured Black A Frame Bases



WELDMARX CIV
96" x 48" White Laminate Top
Two 34" x 30" Salmon Orange V Frame Bases



WELDMARX CIV
72" x 36" Hardwood Walnut Top
Two 34" x 30" Pastel Green A Frame Bases

WELDMARX CV

Rectangular Conference Table



Weldmarx CV is the best fit for formal conference rooms that offer larger spaces. To prevent distractions and to keep the full attention on the presenter during meetings, a 48" depth table is recommended. Various standard sizes and leg options are available to customize your **Weldmarx CV**.



WELDMARX CV
192" x 48" Florence Walnut Laminate Top
Three 46" x 30" Powdered White Eiffel Frame Bases



WELDMARX CV
72" Maple Hardwood Top
Two 34" x 30" Clear Matte A Frame Bases



WELDMARX CV
120" Walnut Hardwood Top
Two 46" x 30" Gloss Black Eiffel Frame Bases



WELDMARX CV
240" Fusion Maple Laminate Top
Four 46" x 30" Gloss White A Frame Bases

#NETWORKING

5-in-1 Ping Pong Conference Table

The **#NETworking** Conference Table is Formaspace Office's answer to the changing function of the conference room and evolution of workplace culture. Furniture doesn't always have to operate for a singular purpose; it can function around many different purposes. With the **#NETworking** table (that's a silent hashtag), we're serving up a multifunctional piece that changes from a sitting conference table to two independently height adjustable collaboration tables, to a standing height conference table, finally into a regulation 5'x 9' ping pong table. While promoting wellness, this product combines work and play. End users gather around the table for an intense table tennis playoff match between in-house rivals, break out into small group collaboration mode with co-workers, and deliver their latest pitch while sitting or standing. The A&D community has asked for truly differentiated, authentic, and unique furnishings. As you may have heard from NeoCon, there's a **#NETworking** revolution happening, only here at Formaspace Office!



STORAGE

WELDMARX XI

Mobile Pedestal

Weldmarx XI is your partner in crime that stores important paperwork, mid-day snacks, gym shoes and any other essential, stationary items. The mobile pedestal can slide under the bench to save space or move next to your desk to offer an alternative seating for quick meetings. Varied sizes, drawer configurations, and countertop options are available to complete the design aesthetics and functionality the end user requires.



WELDMARX XII

Office Credenza

Whether the design aesthetics are mid-century or industrial or modern, adding a credenza to an executive office creates a sophisticated atmosphere. Not only does it support the executive feel, but it also provides space for storage and organization. **Weldmarx XII** is a stylish solution for additional storage space to private offices. Formaspace offers varied sizes, drawer-cabinet configurations, and material options.



WELDMARX XIII

Lateral File Cabinet

Lateral file cabinets are essential to any office that tends to a substantial amount of official documentation and file storage. Committing to a lateral file cabinet that will last a long time and have the right aesthetic that aligns with the overall office design is a challenge. **Weldmarx XIII** eliminates that problem with its unique and flexible design that comes in varied sizes, colors, and materials. **Weldmarx XIII** not only provides the ultimate organization to complicated filing needs but also offers the privacy and protection end users need.



WELDMARX XIV

Bookshelf

If you are looking for sturdy bookshelves for your office, **Weldmarx XIV** is beyond compare with its steel frame and well-balanced stand. It is best suited to match the entire private office suite or with multiple bookshelves lined up to separate the third space from the rest of the open office design. With varied widths, the option of two, three, or four shelves, and multiple material options, **Weldmarx XIV** is a flexible open shelving storage solution for private and open office spaces.



WELDMARX XV

High Back Organizer

Weldmarx XV is an extension unit to the private office credenza, it sits on top of the surface and provides an additional storage space. This unit can be retrofitted to the credenza after original installation. The open steel frame offers a uniquely spacious feel while maintaining durability and an industrial office experience. Varied cabinet options, colors, and materials suited for any office design or look are available.



LOUNGE TABLES

WELDMARX LI

Coffee Table

If the design goal is to create a unique lounge area or to give a more home-like feel to an office space, **Weldmarx LI** is an effective way to accomplish that. **Weldmarx LI**, the coffee table designed for the Weldmarx furniture family, not only adds nice décor to your office but also adds functionality as the “third space” centerpiece and gathering place. Consider using a rectangular coffee table in a collaboration area with soft seating. In any way you need it, request Formaspace Office to customize **Weldmarx LI** to fit into your project’s design.



WELDMARX LII

End Table

Add end tables to casual working spaces, lounges, and in executive offices. The **Weldmarx LII** comes in three widths and depths. This end table sits at 16.75” high. Customize the look with different solid wood surface options or unique laminate tops. Go with the trending industrial aesthetic using the clear powder coat colors, or make it pop in a modern, contemporary, or colorful office with our selection of frame colors. Tell us how you could use this piece in your current project!



COMMUNICATION BOARDS

WELDMARX MI

Mobile White Board

Do you ever need to communicate something visually? This mobile whiteboard is the wingman to your ideas. Since inspiration can hit at random times: during lunch, walking across the office between meetings, or while watching funny YouTube videos, give your end users the freedom to document their creative ideas on **Weldmarx MI**, our mobile communication board. Select from dry-erase, cork, or choose your own material for a customized mobile communication board.



“Ideation to Installation”



“The entire process from design to install was flawless and professional.”

- Cindy, Guardian Pharmacy

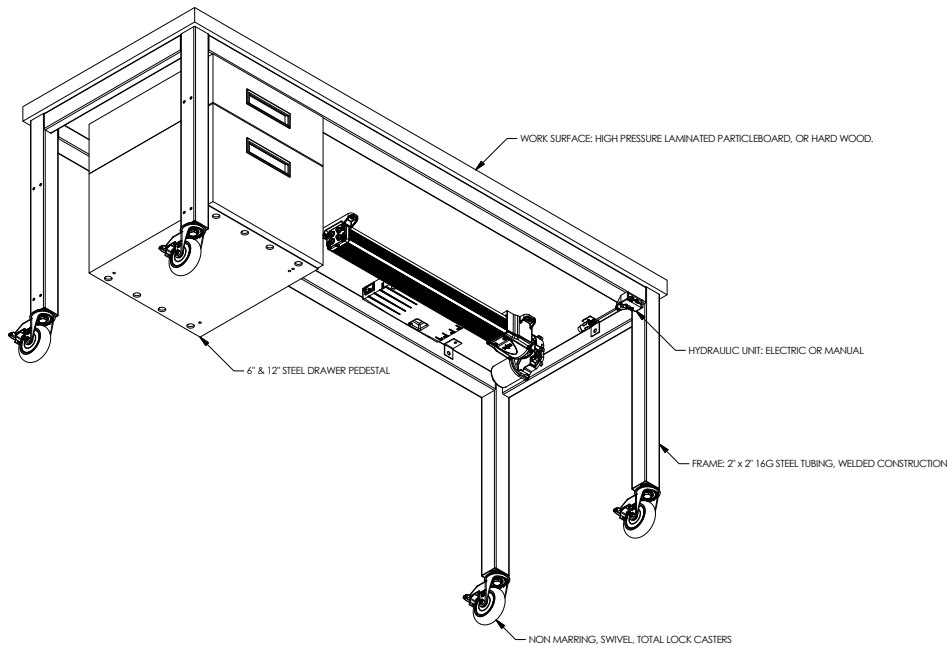

HOW WE DO IT

Formaspace wants to be a part of your project from the beginning until the end. Having one primary point of contact will simplify the implementation of each of your projects.

You can bring your idea to us, and we then design and engineer it to your needs, rapidly prototype it, produce it, deliver it 100% on-time and will easily install your project. We like to call this process “continuous chain of custody.” We want to be a part of your project every step of the way to guarantee success.



HOW TO WORK WITH FORMASPACE

STANDARD PRODUCT

STEPS

1

Inquiry/ Need

2

Engage with
Formaspace

Several Hours

CUSTOM PRODUCT

STEPS

1

Your
Idea

2

Discovery Call with
a Design Consultant

3

Concept Drawing

STANDARD PRODUCT:
5 benches in 5 days
10 benches in 10 days

*ESTIMATED 3 WEEK LEAD TIME
WITH ONGOING ENGAGEMENT

3

Project
Discussion

Average of 1 Hour

4

Quoting Phase

Average of 3 - 4 Days

5

Approval/Order

Average of 3 - 4 Days



*ESTIMATED 10 WEEK LEAD TIME

4

Timeline Budgetary
Quote

5

Approval

6

Drawing

7

Approval/
Order



FACILITY

We manufacture all products in one co-located 60,000 SF headquarters facility in Austin, TX. Since we control every aspect of your project, we ship everything on time.

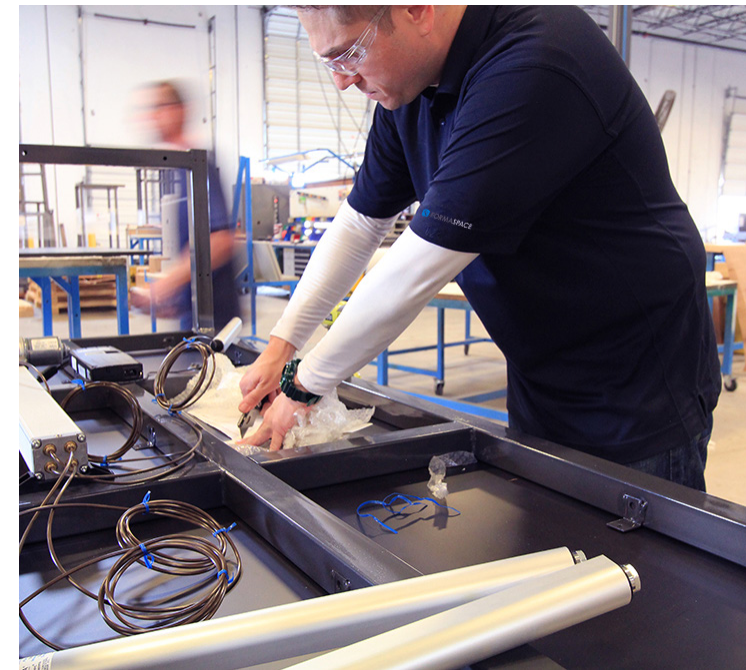

CAPABILITIES

What can we accomplish at Formaspace? Well, a lot. We manufacture 3 different types of furniture. In the office furniture market, we furnish private offices, open floor plans, conference rooms, and reception stations. For laboratories, we furnish both wet and dry labs. For wet labs, we make benching solutions, fixed casework, and sink cabinets. In dry labs, we produce ESD benches and electronic assembly benches. Our final furniture type is industrial. Within this vertical, we manufacture solutions for packing stations, flow racks, and material movement carts. To create these unique furniture solutions, we have CNC routers, automated panel saws, edge banders, and one of the largest powder coating booths in Central Texas.

We have strategically located our facility between our suppliers to provide you with shorter lead times for our 100% American-made product. You dream it, we design, fabricate, and install it!



TEAMS

Behind your single point of contact for large products is an entire team dedicated to your success. Our team of consultants, project managers, and senior team leaders will execute your project from start to finish with the help of our factory labor.

You can bring your idea to us, and we then design and engineer it to your needs, rapidly prototype it, produce it, deliver it on-time and can install your project.



EXECUTIVE TEAM



JEFF TURK, CEO

Jeff is mostly charged with solving unique workplace furniture problems, particularly in laboratory settings. After selling his first company in high school, Jeff honed his talents at Southern Methodist University (BBA) and the Kellogg School of Management at Northwestern University, where he earned a Master's degree with specialties in entrepreneurship, innovation & operations. Between and after graduations, Jeff has had the opportunity to work with more than 25 startups on four continents, eat a python steak, dive the Devil's Throat, jump out of a couple of perfectly good airplanes, help obtain more than \$1 billion in badly needed debt forgiveness for a West African country, and serve as a volunteer search and rescue helicopter pilot serving the citizens of the state of Texas. He can wax poetic about any number of super-cool designs he has worked on at Formaspace and is a frequent speaker at several universities including Northwestern, Harvard, and the University of Texas.



**FRANK BUCHER,
EVP of SALES**

Nicknamed Frank the Tank, Frank has over 21 years of sales and sales management experience. Most recently, he worked for BKM Total Office of Texas located in Dallas as their Executive Vice President of Sales and Marketing. While there, he provided sales structure and leadership during a time of corporate transition. A "sports has been", he played football in college and the sport has continued to be one of his favorites. Ohio State currently holds the title of his favorite sports team. Be sure to give him some grief the next time you see him! Frank is the hub of Formaspace's brewing energy. You can find him walking around the office at 9 a.m. announcing "Top of the morning to ya" to anyone that will make eye contact. His demeanor and humor around the office are sure to put a smile on anyone's face.



**MARK PROFFITT,
VP of OPERATIONS**

Mark leads Production, Industrial Design & Engineering, IT, Supply Chain, Customer Service, and Shipping Operations. Mark started his career in the military; he's a service-connected Disabled Navy Veteran with service medals. With more than 20+ years in the manufacturing industry, Mark worked his way up from the shop floor as Maintenance & Production Team Leader through positions of increasing responsibility to become the customer and quality-focused operations leader he is today. His level of focus and professionalism is reflected in his goals for Formaspace. Outside of work, Mark enjoys weekend getaways, where you can often find him hiking, rock climbing, mountain biking, and site-seeing. He's also an avid movie-goer and loves to barbecue and cook.



SALES TEAM

We have a dynamic mix of customer reps and senior sales people to help you navigate your project. Combined, our team has over 65 years of knowledge in this industry. Design consultants can help spec your project and design support specialists support our clients before, during, and after your order is placed. Our sales team is here to help guide you and answer any questions you may have during every step of the process!

ENGINEERING AND PROJECT MANAGEMENT

At Formaspace, the Design & Engineering Team becomes an extension of our client's core team. We will engage and participate at whatever level each client desires; from weekly team meetings to monthly updates, we come alongside as you wish and take ownership of the assigned tasks to remove the furniture worries from your project.

The Formaspace Design and Engineering Team has a wide range of experience, training, and capabilities to address a multitude of project demands. These capabilities range from Industrial Design, Project Management, 3D Solid Modeling, 2D Drafting, through NC Programming. Additionally, this resource pool can develop, document, and illustrate complex product details via renderings and CAD visualization in electronic or print format. Our team utilizes Autodesk Inventor 3D software, AutoCAD 2D drafting tools, and Revit when specified. With 50+ years of combined furniture knowledge housed within the Formaspace Team, we are your go-to body of knowledge for all types and styles of furniture products; from office furnishings, laboratories, to material handling and industrial workbenches.

Our internal touch for quality and validation methods have resulted in overall ideation to shipped product process that delivers 98% first-pass yield for engineering information into our production facility. This allows our shop to build it right the first time and deliver orders at an amazing 3-week lead time, with most orders shipping early.

PRODUCTION & INSTALL TEAM

Our production team consists of 5 departments that each specializes in a unique function of production such as assembling products or powder coating frames. Each department handcrafts the benches at our headquarters in Austin, TX to ensure the utmost quality control and oversight. Many people on the production team staff have been at Formaspace for over 20 years and are, therefore, experts at creating a quality, durable products that will be sure to impress any client!

For installations, we offer several services that can best fit your project. We can provide you with a trained nation-wide installation service, a nation-wide installation service that is supervised by one of our Project Managers, or a dedicated team of Formaspace individuals who put the product together and are experts at installing it. No matter what your project needs, Formaspace will provide the services to get your benches set up quickly so you can focus on what you do best!



"The people I talked to were very knowledgeable about their craft and were very collaborative. They made sure that the right questions were asked about the designs we were looking at and helped us at each stage of the design process for our instrument tables."

- Nathan, CMC Biologics



MARKETING TEAM FOR OFFICE CHANNEL

Our marketing team will support your sales efforts under the leadership of our Brand Manager, Digital Marketing Manager, and highly talented developers, writers, designers, videographers, and specialists. Our Marketing team is an extension of your team of reps and dealers in channel sales of our office products. We can help with email campaigns, showrooms, samples, and even help plan events. Learn more about how our Marketing team can help support your brand!



CUSTOMER SERVICE AND SUPPLY CHAIN

Our dedicated customer service representatives will be there to serve you with any post-purchase questions you may have. Whether it is replacement parts, shipping updates, or various other needs that might arise, count on our reps to get you taken care of quickly.



“ ”

“Outstanding customer service and great quality products. Have used Formaspace for right at 10 years now and can say I have been completely satisfied throughout.”

- Undisclosed Business Client

SERVICES

Workbench Design

Whether an industrial desk is needed for manufacturing or any material handling operation, we offer you a dedicated team of designers to help design the workplace of your dreams. Our engineering team will work with you closely to engineer a solution. Contact us for renderings and design help on your next project!

Installation as a Service

We offer 3 different installation services depending on your budget. Our first option is a crew of talented nation-wide installers that we trust, to come and install the benches for you. The next option we offer includes a nation-wide installer team that we partner with, supervised by a Formaspace project manager to make sure the install runs smoothly. The top tier service provided is a Formaspace project manager accompanied by a team of trained Formaspace production members to install your benches for you. Our team knows the ins-and-outs of our product and can quickly and efficiently get you up-and-running. Full-service installation is strongly suggested on highly custom projects exceeding \$50,000 in product value, as well as more standard projects where the workstation budget exceeds \$100,000. No matter what your project needs, Formaspace will provide the services to get your benches set up quickly so that your facilities are up and running!

On-Site Survey

We offer several unique services to better serve our customers. One of those services is a Rapid Plant Assessment. With over 30 years in furniture fabrication and in-depth knowledge of LEAN manufacturing, our senior leaders provide consultation services that include site surveys, operator interviews, and current state process evaluation. Book your RPA to see the highest return on your manufacturing workstation investment.

“ ”

“Strong, dependable benches with high quality construction.”

- SlipChip





CASE STUDY

Formaspace has successfully completed a number of projects over the past 35 years, including a number of a few marquis projects that demonstrate what Formaspace can accomplish in the face of its own unique challenges. We address each issue and exceeded client expectations.

Take a moment to read a little about our work at the laboratories, a major tech company, a major finance company that we help with a variety of solutions!

DIES

executed many notable
ars. Here are four case studies
demonstrate the scope of
plish. Each project presented
found custom solutions to
nt expectations.

bit more about two wet
npany, and a consumer
bed with business furniture





CASE STUDY

Ariosa Diagnostics Laboratory



Modular Lab Benches

Housed in a Santa-Clara incubator, Ariosia's founding team called Formaspace to create a unique table to support DNA sequencing. When Ariosia expanded from 1 test a day to 20 tests per day, we completed a \$250,000 project primarily based on the original design. When they recently expanded 20 tests a day to 20,000 tests a day, we partnered with Ariosia again to help the company work through some of the problems created by growth exceeding 1000% per year.

PROBLEM

Explosive growth is exciting but comes with its own set of problems. It is relatively easy to test one person's DNA, and it's easy to dispose of one person's waste. You're not likely to have any problems losing or mixing up one blood sample a day, or creating accurate results, or keeping the sequencer clean, and there is not likely to be any cross-contamination. You don't worry a whole lot about the process flow because it's all done by one person. However, with the explosive growth of a few tests a day to several thousands of tests a day, how do you keep up? With people's livelihood and quality of life on the line, how do you ensure accuracy?

SOLUTION

Formaspace built modular benches for total flexibility, solving multiple problems inherent in high volume DNA testing labs. We created high weight capacity benches on casters for mobility. There are continuous grommets towards the back of the surface so that power, data, and effluent can be placed anywhere. We used phenolic surfaces for ease of cleaning and added cabinets for accessible storage. We also designed a custom cart so that lab techs could easily dispose of the waste without creating a potential for mess or disease.

RESULTS

We helped Ariosia massively reduce its labor cost from handling liquid waste. Our solution also significantly decreased turnover of lab personnel as Ariosia became one of the best places to work in the valley. We helped the company support massive growth, while still maintaining test quality.

PROJECT SCOPE DETAILS

END USER: Ariosia, a Roche Diagnostics Company

PROJECT SIZE:
\$2 million

ASK YOURSELF...

How would you feel if you lost a blood sample that a new mother depended on to know whether her baby has a trisomy? Even worse, what happens when samples become cross-contaminated, and a mother is told her baby has a genetic defect and doesn't, or vice versa? And even worse, what happens when a lab tech comes into contact with diseased human waste? How do you even plan for simple things during explosive growth and technological change?





Casework Solution

After the U.S. invaded Iraq and Afghanistan, U.S. military canines capable of sniffing out improvised explosive devices were poisoned. The U.S. Army reasoned that if the enemy could poison dogs, they could poison soldiers, and if they could do that, what could stop them from poisoning our domestic food supply? Tasked with building one of the nation's largest food diagnostic laboratory, the Corps of Engineers, as part of the Bush administration's overall emphasis on biocontainment, needed a quick laboratory furniture solution.

PROBLEM

An incumbent lab casework vendor was declared to be in default on the \$2 million+ job, forcing the GC to cancel the contract. To avoid liquidated damages, the GC reached out to Formaspace and wondered if they could perform under the pre-existing tight timeline. The Army's lab space featured challenging building conditions including a very uneven floor, wavy walls, and new walls that misaligned with architectural drawings.

SOLUTION

The Formaspace team attended weekly construction meetings and delivered on-time without a single damaged cabinet on a \$2.2 million project. Due to our outstanding performance, Formaspace was asked to also complete work such as mechanical requirements that were outside of the original scope. Formaspace furnished the lab with Formaspace casework, modular bench solutions, mobile pedestals, epoxy sinks, eyewash stations, and upper cabinetry.

RESULTS

The furniture for one of the largest Food & Drug Diagnostics Labs in America was designed, manufactured, and delivered on time, liquidated damages avoided, and Formaspace was awarded a 10/10 satisfaction score from our client, who has become one of our closest government partners.

PROJECT SCOPE DETAILS

END USER: Ft. Sam Houston
Food Diagnostics Lab, U.S.
Army

PROJECT SIZE: \$2.2 million

LAB SIZE: 40,000 sq. ft.
LEED Silver Renovation





CASE STUDY

Ft. Sam Houston Food Diagnostic Lab (FADL)



CASE STUDY

DELL - TECH LAB



PROJECT SCOPE DETAILS

ARCHITECT: CTA Architects
END USER: Dell
PROJECT SIZE: \$1 million

Tech Lab Benches

Dell has been a Formaspace client for more than 25 years. Over the years, we have provided the company with tech lab, manufacturing, office, retail, and even residential furniture. In late 2015, Dell decided to co-locate its global labs back to Austin, Texas. The company projected a cost of \$100 million to expand its Round Rock Lab building, furnish the lab space, and bring their engineers home.

PROBLEM

Unfortunately, managers were charged with making this co-location happen, but not awarded the budget to do it. The lab managers were stuck between a rock and a hard place and needed to find a feasible solution quickly.

SITE SURVEY DISCOVERIES

Formaspace sent a team to the site and discovered that each test server at Dell costs over half a million dollars. R&D servers are unique, one of a kind prototypes. If they are dropped, or have ESD failure, the company loses \$500,000 and time spent on development.

Servers are very dense and heavy, and they easily slide around on laminate surfaces. Additionally, ESD failure can happen without notice and be completely untraceable. Issues may not come to light until months or years later. With the existing configuration of the benches, technicians were spread out across three workbenches, and only able to test one server at a time.

SOLUTION

Formaspace partnered with CTA Architects to evaluate Dell's spatial needs and laboratory workflow for server testing. We designed a condo rack, moving shelf bench, and an ergonomic, height adjustable ESD workstation for technicians.

PRODUCTS

01

The Condo Rack

This product allows technicians to test up to four servers simultaneously, **increasing throughput by up to 400%**. Features of the condo rack design included testing servers placed on top of the shelves and out of the way, heavy duty pull-out shelves with locking tabs, high weight capacity lock-in lock-out slides, and removable sides for retaining servers.

02

Moving Shelf Bench

Shelf supports two \$500,000 oscilloscopes, which need to be out of the way for testing, but accessed between tests.

03

Height Adjustable ESD Workstation for Technicians

We paired the custom units with economical standard products. Formaspace worked in conjunction with Dell to ensure that monitoring tests became mostly automated, meaning no one had to physically sit and watch the entire 24-36 hour testing regimen, potentially saving millions of dollars annually. We implemented 24/7/365 ESD testing and monitoring, eliminating the potential for ESD failures and eliminating several hundred thousand dollars of mat costs annually.

Saved Dell over 37% of R&D tech lab space and **\$84 MILLION** in construction costs with our furniture solution.

01



02



03



RESULTS

Construction savings of **\$84 million** on an original \$100 million budget (less than \$1 million in furniture). The condo rack solution **saved 37% of floor space**, eliminating the need for a new building. The 24/7/365 ESD testing and monitoring solution reduced the potential for ESD failures and saved Dell several hundred thousand dollars of mat costs annually. The height adjustable ESD workstation helped Dell save millions of dollars annually in labor savings.

C¹ CAPITAL ONE LABS

Capital One Labs, an experimental product and technology team operating as a start-up accelerator within the global consumer finance company, Capital One, wanted to create a dedicated “lab” space where it designs the consumer financial products of the future.

PROBLEM

Capital One Labs was looking for a modular desk that could be moved around to multiple electrical and data hubs for easy collaboration. They wanted something different and authentic that had an industrial aesthetic. The Weldmarx I desk was developed in conjunction with One Workplace as a unique solution to Capital One’s specific business needs.

SOLUTION

Our Industrial Design Team created Weldmarx I, a height adjustable desk with an attached mobile pedestal, which allows end users to move freely about the office with one piece of furniture to promote cross-departmental collaboration. The hydraulics and fully welded steel frame give the bench height adjustability as well as a 1,000-pound weight capacity. This height adjustable desk was even tested to double BIFMA standards.

PROJECT SCOPE DETAILS
DEALER: One Workplace
END USER: Capital One Labs
PROJECT SIZE: \$2 million
PRODUCT: Weldmarx I



RESULTS

Eight Hundred Weldmarx I desks were installed in Capital One Labs’ California offices and gave end users the freedom to move about the office and work where they desire, using an industrial-chic height adjustable desk. The furniture is designed with young professionals in mind. Features include solid hardwood tops (ash), retractable power cords combined with casters for easy movement and collaboration, USB ports for charging devices, and hydraulics for sit to stand capabilities. The steel frame is powder coated in matte clear, showcasing the weld marks and natural imperfections of the steel. Paired with a hardwood surface, these desks create a natural, authentic, and unique look. We call this “modern industrial.” Weldmarx was well accepted based on the employee satisfaction results below.

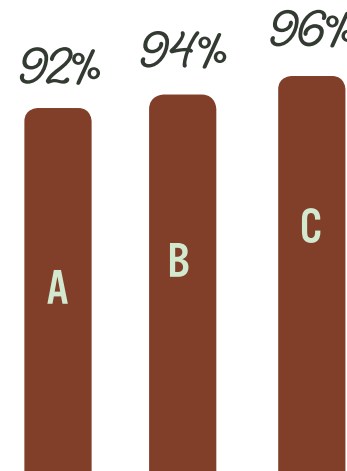

GREAT PLACE TO WORK conducted a survey with employees that work in the office after our furniture was installed. Capital One Employee Ratings:
A: “Great Atmosphere”
B: “Great Communication”
C: “Our facilities contribute to a good working environment.”



TPC1 9/8

12

CASE STUDY

Capital One Labs - San Francisco Office

SEMO
MA



VERTICALS

Formaspace has three main verticals: laboratory, industrial, and office furniture. Our laboratory solutions include furniture for wet labs, tech labs, and clean rooms. Industrial includes any work surface that is found in manufacturing, assembly, or packing & shipping facilities. Lastly, office solutions include any type of desking furniture from conference tables to storage; we make it all! Throughout our verticals, you can see a common theme of an industrial designed look and feel. No matter what product you order from Formaspace, rest assured that they are all durable, long-lasting, and unique benches.

01

LABORATORY

Modular furniture designed to your specs that withstands corrosive chemicals and protects tomorrow's technology from electrostatic discharge.

02

INDUSTRIAL

Durable workstations designed for safe, efficient, ergonomic production environments.

03

OFFICE

Differentiated and authentic office furniture designed for collaboration, productivity, and to inspire the next big thing.



LAB APPLICATIONS

Wet Lab Furniture Solutions

When innovation matters, trust Formaspace to custom engineer a task-specific wet lab, build durable workstations resisting the strongest of chemicals and deliver on-time without laboratory downtime. Not exactly sure what you need? Our designers will give you a free, no-obligation consultation complete with 3D design renderings.

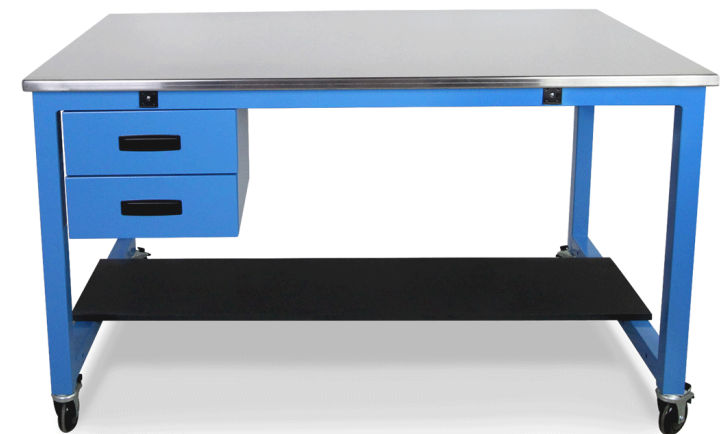





Tech Lab Furniture Solutions

When innovation matters, trust Formaspace to custom engineer a task-specific dry lab, build durable workstations with continuous monitoring that grounds electrostatic buildup and deliver on-time without lab downtime. Not positive what you need? Our designers will give you a free consultation complete with 3D design renderings.

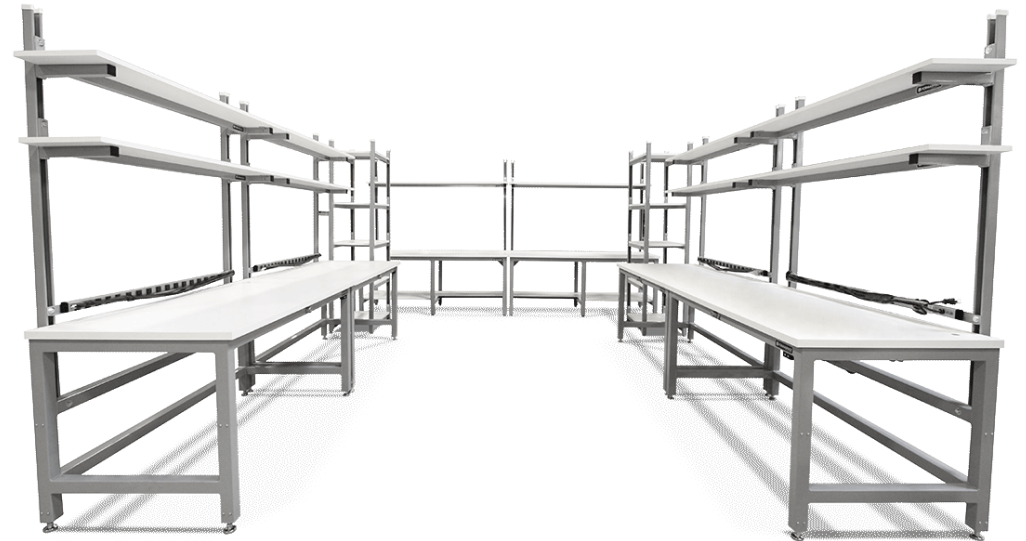



INDUSTRIAL APPLICATIONS

We manufacture workbenches in several different verticals. Whether it is manufacturing, assembly, or shipping & packing workstations, Formaspace has you covered. We create flexible, heavy-duty benching solutions that advocate for an efficient, LEAN environment. We design and manufacture solutions to maximize productivity, safety, and organization.





Makerspace Solutions



WHAT MIGHT HAPPEN IF EVERYONE COULD HAVE ACCESS TO EXTRAORDINARY TOOLS?

People everywhere are beginning to collaborate, invent, and discover new materials, technologies, and art forms in well-equipped spaces. Whether you're building a Fab Lab for CNC routing and circuit board fabrication or an educational facility's makerspace, Formaspace offers top of the line furniture for a wide range of innovative spaces. Our materials withstand student exploration of crafts and curious techies heavy-duty tinkering. House expensive equipment on our modular furniture known for its durability and strength. Provide your clients with workstations that encourage creativity.



Educational Facilities

From Makerspaces to innovation labs, to custom library tables, Formaspace has the right solution for you. We can help build any space that will help students work more productively and efficiently.

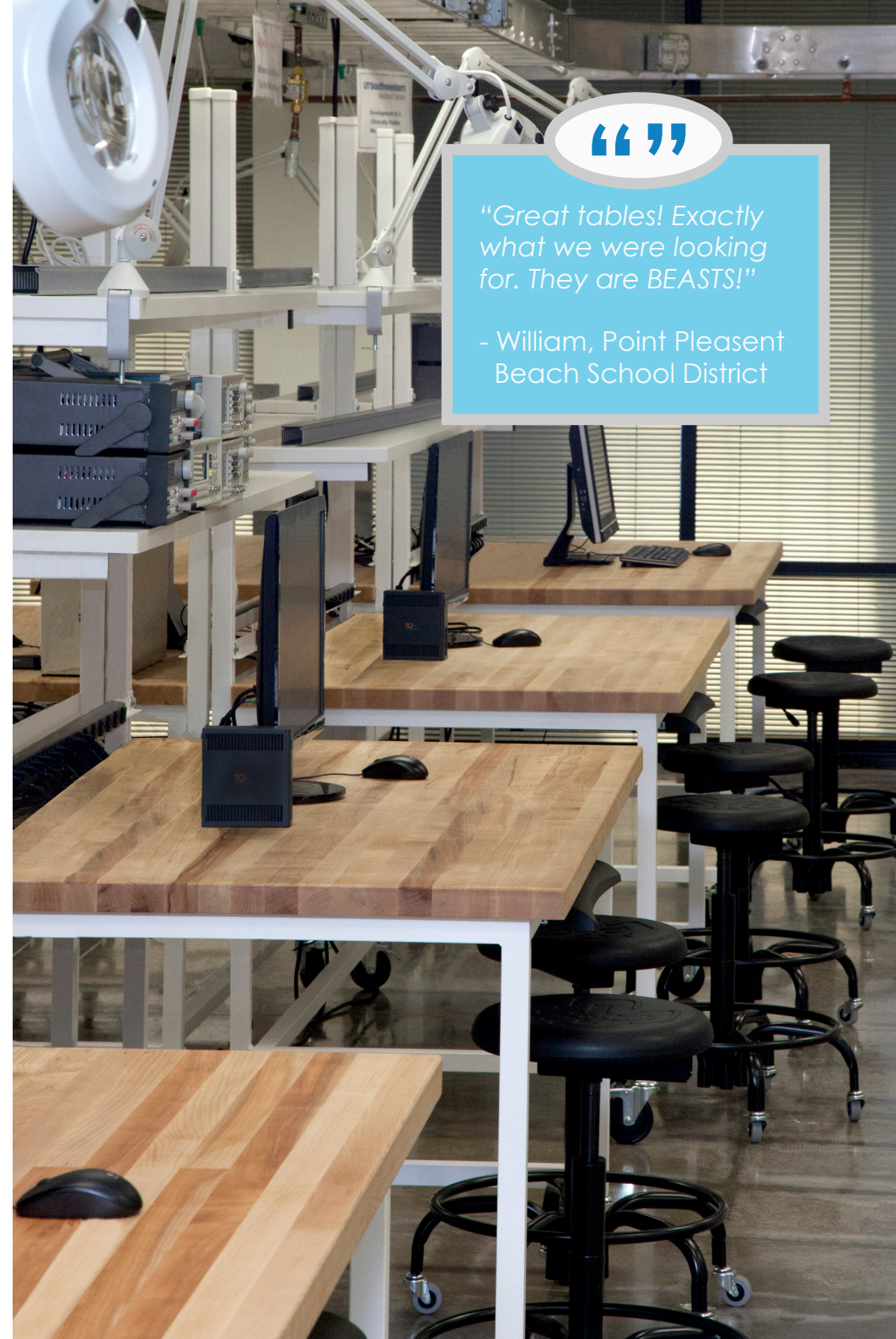

“ ”

“Great tables! Exactly what we were looking for. They are BEASTS!”

- William, Point Pleasant Beach School District





OFFICE FURNITURE APPLICATIONS

Formaspace Office can provide solutions for multiple applications such as open offices, executive offices, conference rooms, and lounge/cafe areas.

OPEN OFFICE

Open office designs are in. That is why we have created furniture to compliment that. Open offices are critical to collaboration and provide an inclusive office culture. It fosters a more creative and communication-based environment.

PRIVATE OFFICE

Desking solutions are also needed in more private spaces, and that is why we designed a whole set of sleek and industrial looking desking solutions. Executive spaces come with a different set of needs that we made sure to take into account.

UNIQUE MEETING TABLES

In addition to our standard line of conference tables, we also have the ability to make custom conference tables for more unique needs. We can create custom ping pong tables that are blue tooth enabled and can separate into 2 individual collaboration tables. Have something else in mind? We can build that too!

LOUNGE & CAFÉ SPACES

There are several benefits of having an office café. With millennials being the largest generation in the workplace, an office cafeteria and lounge will help attract and retain new talent for your clients. Break out spaces also assist in creating a social environment where employees have the opportunity to network and collaborate.

SEE MORE AT FORMASPACEOFFICE.COM



*Scan this code to view
industrial office furniture line!*





"Formaspace is quick to respond and ships when they say they will." - Sheryl, Tangram Interiors

FORMASPACE OFFICE 3DCONFIGURE

Design Unique and Custom Desks and Conference Tables in 3D

1. Select an Office Desk Product

ENTER FULLY CUSTOM DESIGN CONFIGURATOR
Design Unique Custom Desks and
Conference Tables in 3D

3DCONFIGURE OFFICE DESKS
Select a Office Desks Product

 **WELDMARX I**

 **WELDMARX II+**

 **WELDMARX III**

 **WELDMARX IV**

 **WELDMARX V**

 **WELDMARX VI**

 **WELDMARX VII**

2. *Customize product with different tops, frame colors, bases, and accessories*

WELDMARX I

Sit to Stand Desk

WIDTH

60" 72"

DEPTH

24" 30" 36"

TOP

WOOD LAMINATE

TOP COLOR

MPL

3. *Easily Save or Share the Design*





CUSTOM FURNITURE SOLUTIONS

In addition to the standard product lines that Formaspace offers clients, we also offer our abilities to create custom solutions. Do you have a major problem that needs to be fixed? Do you have a unique space that requires unique furniture? Do you need your new furniture to match your existing furniture? Formaspace is here to help you every step of the way. Contact us to see how we can upgrade your current space!



"We purchased custom tables each time we've ordered from Formaspace, all items have been the highest quality and exceeded our expectations. They are professional and easy to work with."

- Teri, Huhtamaki



FORMASPACE MATERIALS & FINISHES

BUTCHER BLOCK



Maple



Oak



Cherry

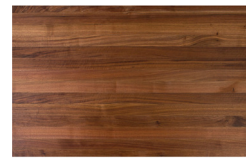

Walnut

LAMINATES



Black



Gray



White

EPOXY RESIN

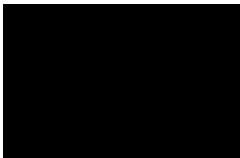

Black



Gray

PHENOLIC RESIN

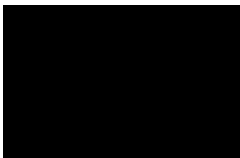

Black



Gray



White

HIGH DENSITY POLYETHYLENE



Black



Gray



White

STAINLESS STEEL



Stainless Steel

POWDER COAT COLORS



Black Semi Gloss
BK 266

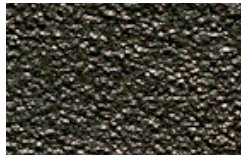

Black Texture
BK 59



Steel Gray Pearlescent
T028GR02



Gray
RAL 7045



Light Gray
RAL 7035



Eco Gray
VARIES



White Gloss
WH 11



White Texture
WH120



Clear Coat Matte
CL 01



Clear Coat Gloss
CLRM



Red
RD 01



Sapphire Blue
RAL 5003



Traffic Blue
RAL 5017



Blue
RAL 5012



Light Ivory
RAL 1015



Light Neutral
HHS5 60021



Almond
BG 01



Custom

FORMASPACE ACCESSORIES

POWER



Power Strip - 24", 36", 48"

OVERHEAD LIGHT



LED Light - 24" or 48"

HEIGHT ADJUSTABLE

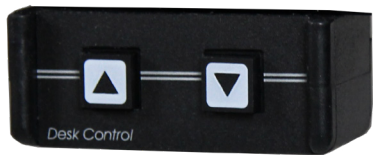

Electric Hydraulics



Manual Hand Crank

MAGNIFYING GLASS



GROMMET



Adjustable Leg Kit

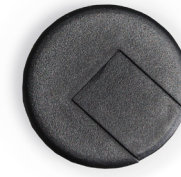

CASTERS AND LEVELERS



Total Lock Caster



Standard Leveler



Heavy-Duty Plate Caster



Leveler



Caster-Leveler Combo

KEYBOARDS



MONITOR MOUNTS



7-Flex Articulating Monitor Mount



LCD-4 Monitor Mount

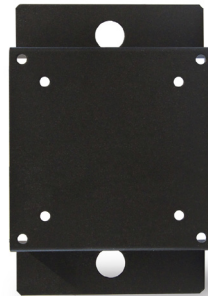

Static Monitor Mount



Keyboard and Monitor Mount Combo



CPU Holder Mount

FORMASPACE OFFICE MATERIALS & FINISHES

HARDWOODS



Maple



Oak

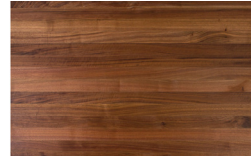

Walnut

LAMINATES



5th Avenue Elm



Carbon Mesh



Fusion Maple



Florence Walnut



Astro Strandz



White



Black



Putty



Beige



Sprout

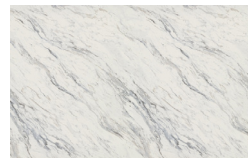

Calcutta Marble

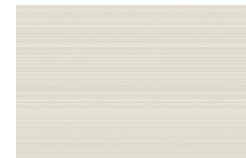

High Rise

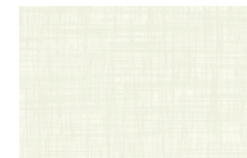

Magnolia



Mushroom

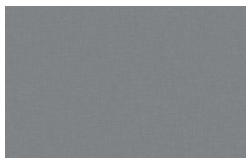

Battleship

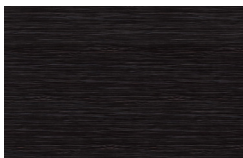

Madagascar

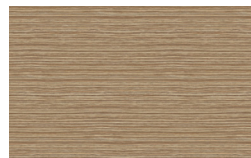

Buka Bark

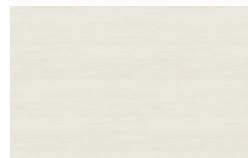

Phantom Pearl



Charcoal Velvet



Regimental Red



Slate Grey

MATERIALS & FINISHES CONT.

LAMINATES CONT.

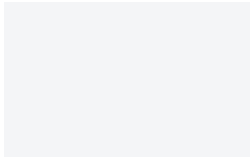

Designer White

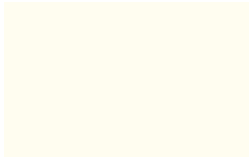

Linen



Island



Ocean



Cement



Lace Gesso Wood



Bellini Blue



Maize Walnut Crossgrain

POWDER COAT COLORS



Matte Clear
CLRM

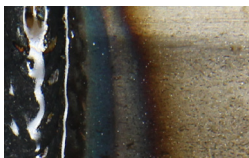

Gloss Clear
CL01



Textured White
WH120



Gloss White
WH11

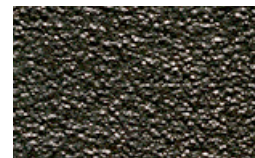

Textured Black
BK59

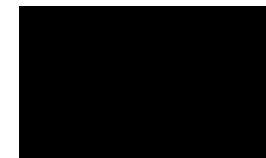

Gloss Black
BK266

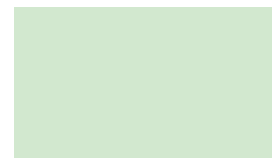

Pastel Green
RAL 6019



Pastel Blue
RAL 5024



Salmon Orange
RAL 2012



Pearl White
RAL 1013



Satin Nickel
HM512S14



Burgundy
HS212R7



Navy
HS212B518

POWDER COAT COLORS CONT.



Sage
RAL 6021



Turquoise
RAL 6027



Beige Gray
RAL 1019



Melon
RAL 1028



Golden Hour
RAL 1018



Fern
RAL 6025



Silver Gray
RAL 7001



Violet
RAL 4008



Mauve
RAL 4009

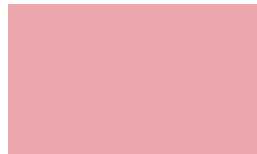

Rose
RAL 3015



Rust
RAL 8023

FORMASPACE OFFICE ACCESSORIES

ELECTRICAL ACCESSORIES



PCS73



Dock 201



Dock 271

MELAMINE DRAWER PULLS - 96 mm



Steel Bar Handle



Steel Crescent Handle



Steel Wire Handle

CASTERS AND LEVELERS



Caster



Leveler

3" Grommets



LEARN MORE ABOUT OUR PRODUCTS BY VISITING US ONLINE!



FORMASPACE

www.formaspace.com
www.formaspaceoffice.com

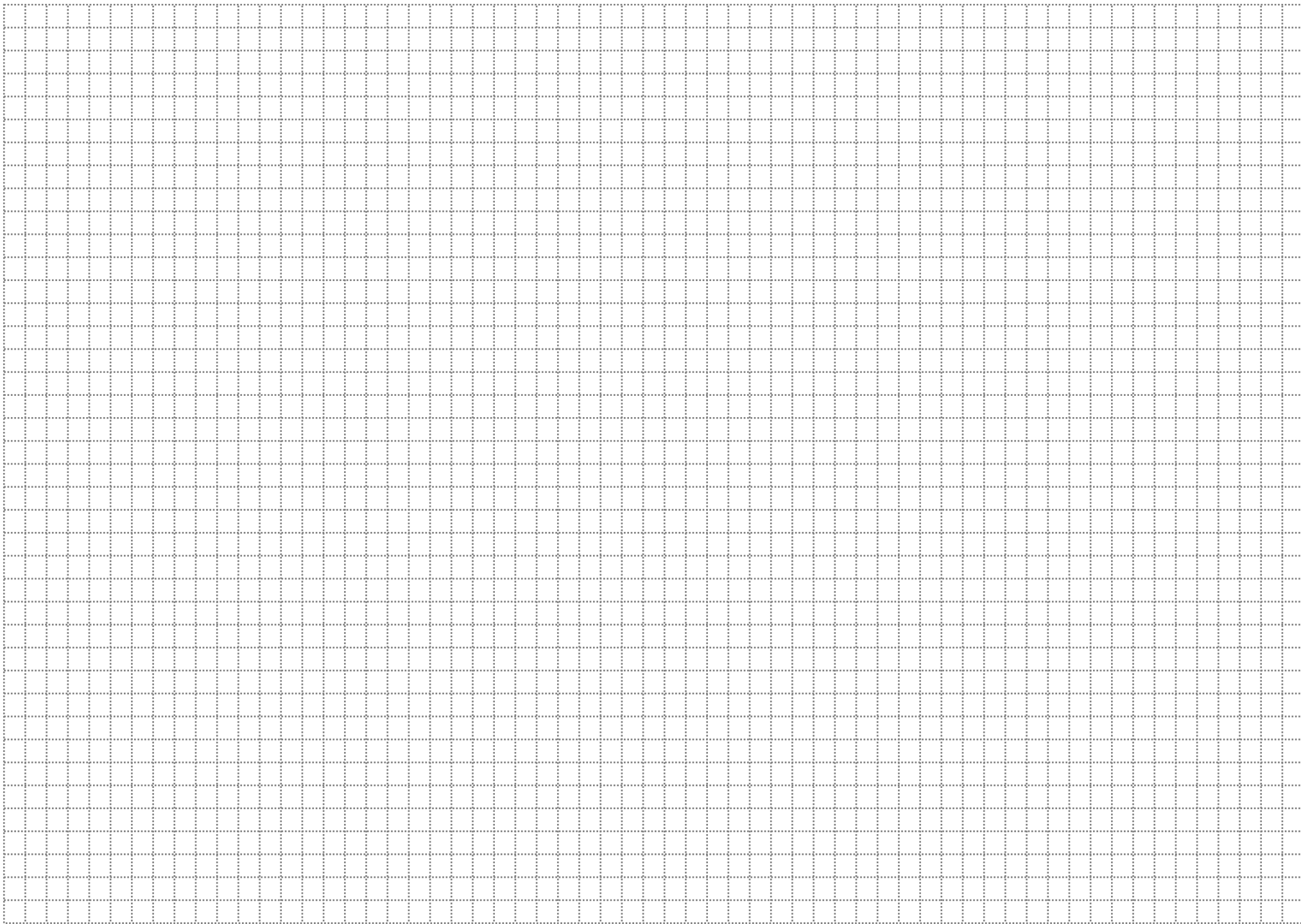



HEADQUARTERS

1100 E. Howard Lane Suite #400 Austin, TX 78753
design.consultant@formaspace.com
formaspace.com
800.251.1505